

Siguranțe fuzibile tip D

Date tehnice	
Tensiune nominală U_n	500 V a.c., 600 V a.c., 750 V a.c., 1200 V a.c., 400 V d.c.
Curent nominal I_n	DI, DII 2 - 25 A, DIII 32 - 63 A DIV 80 - 100 A, DV 125 - 200 A
Capacitate de rupere la $1,1 U_n$	50 kA a.c. $\cos\phi = 0,2$ 8 kA d.c. $T = 15 \text{ ms}$
Caracteristici de siguranță	gG, TDZ, DZ
Clasă de izolare	C - VDE 0110
Standarde	DIN EN 60269-1, IEC 60269-1:2005-04 (VDE 0636 Teil 10): 1999-11 DIN EN 60269-3, IEC 60269-3:2003 (VDE 0636 Teil 30): 1995-12 DIN EN 60269-3-1, IEC 60269-3-1: 2004-07 (VDE 0636 Teil 301): 1998-01 DIN VDE 0635/02.84

DI pentru soclu siguranță E16

I_n [A]	dimensiuni	
	$\varnothing A$	$\varnothing B$
2	13,2	6
4	13,2	6
6	13,2	6
10	13,2	8
16	13,2	10
20	13,2	12
25	13,2	14

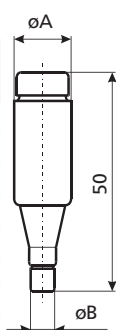

DII pentru soclu siguranță E27

I_n [A]	dimensiuni	
	$\varnothing A$	$\varnothing B$
2	21,5	6
4	21,5	6
6	21,5	6
10	21,5	8
13	21,5	8
16	21,5	10
20	21,5	12
25	21,5	14

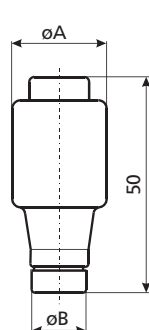

DIII pentru soclu siguranță E33

I_n [A]	dimensiuni	
	$\varnothing A$	$\varnothing B$
32	27	16
35	27	16
40	27	16
50	27	18
63	27	20

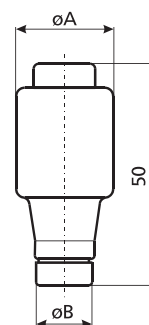

DIV pentru soclu siguranță R1 1/4"

I_n [A]	dimensiuni	
	$\varnothing A$	$\varnothing B$
80	33	5
100	33	7

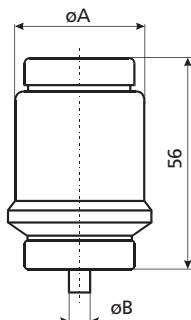

DV pentru soclu siguranță R2"

I_n [A]	dimensiuni	
	$\varnothing A$	$\varnothing B$
125	46	5
160	46	7
200	46	9

**DIII gG, 690 V a.c.,
600 V d.c.**

I_n [A]	dimensiuni	
	$\varnothing A$	$\varnothing B$
2	27	6
4	27	6
6	27	6
10	27	8
16	27	10
20	27	12
25	27	14
35	27	16
50	27	18
63	27	20

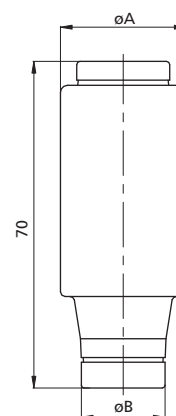

DIII gF, 750V a.c.

I_n [A]	dimensiuni	
	$\varnothing A$	$\varnothing B$
2	27	6
4	27	6
6	27	6
10	27	8
16	27	10
20	27	12
25	27	14
35	27	16

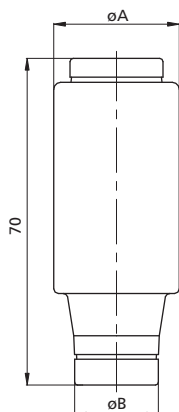

DIII gF, 1200 V a.c.

I_n [A]	dimensiuni	
	$\varnothing A$	$\varnothing B$
2	27	6
4	27	6
6	27	6
10	27	8
16	27	10
20	27	12
25	27	14
35	27	16

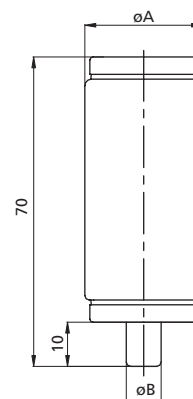



D

