

## Separatoare generale LA

Date tehnice pentru separatoare generale LA (IEC 60947/1-3):				LA1	LA2	LA3	LA4	LA5	LA5 50kA							
Tip				160A	250A	315A	400A	630A	800A	1000A	1250A	1250A	1600A	2000A	2500A	3150A
Curent nominal	(In)			160A	250A	315A	400A	630A	800A	1000A	1250A	1250A	1600A	2000A	2500A	3150A
	(Ui)	(V)	(V)	1000	1000	1000	1000	1000	1000	1000	1000	1000	1000	1000	1000	1000
Tensiunea nominală de izolare	AC	(Ui)	(V)	1000	1000	1000	1000	1000	1000	1000	1000	1000	1000	1000	1000	1000
	DC	(Ui)	(V)	1500	1500	1500	1500	1500	1500	1500	1500	1500	1500	1500	1500	1500
Rezistența la impulsul de tensiune	(U imp)	(kV)	(kV)	8	12	12	12	12	12	12	12	12	12	12	12	
	(Ith)	(A)	(A)	160	250	315	400	630	800	1000	1250	1250	1600	2000	2500	3150
Curent nominal termic	400V	(A)	(A)	125/160	250	250/315	400	630	630/800	1000	1250	1250	1600	2000	2500	3150
	500V	(A)	(A)	125/160	250	250/315	400	630	630/800	1000	1250	1250	1600	2000	2500	3150
Curent nominal	690V	(A)	(A)	125/160	250	250/315	400	630	630/800	1000	1250	1250	1600	2000	2500	3150
	400V	(A)	(A)	125/160	250	250/315	400	630	630/800	1000	1250	1250	1600	2000	2500	3150
Curent nominal	500V	(A)	(A)	125/125	250	250/250	400	630	630/800	1000	1250	1250	-	-	-	-
	690V	(A)	(A)	125/125	250	250/250	400	630	630/800	1000	1250	1250	-	-	-	-
Curent nominal	400V	(A)	(A)	125/125	250	250/250	400	630	630/800	1000	1250	1250	-	-	-	-
	500V	(A)	(A)	100/100	200	200/200	315	500	500/500	800	800	1000	-	-	-	-
Curent nominal	690V	(A)	(A)	80/80	160	160/160	250	400	400/400	400	400	800	-	-	-	-
	220V	(A)	(A)	125/160	250	250/315	400	630	630/800	1000	1250	1250	1600	2000	-	-
Curent nominal	420V	(A)	(A)	-	250	250/315	400	630	630/800	-	-	-	-	-	-	-
	560V	(A)	(A)	-	60	60	400	630	630/800	-	-	-	-	-	-	-
Curent nominal	220V	(A)	(A)	125/125	250	250/315	400	630	630/800	1000	1250	1250	-	-	-	-
	420V	(A)	(A)	-	250	250/250	400	630	630/800	-	-	-	-	-	-	-
Curent nominal	560V	(A)	(A)	-	40/60	40/60	400	630	630/800	-	-	-	-	-	-	-
	220V	(A)	(A)	80/80	250	250/250	400	630	630/800	630	800	800	-	-	-	-
Curent nominal	420V	(A)	(A)	-	250	250/250	400	630	630/800	-	-	-	-	-	-	-
	560V	(A)	(A)	-	-	-	400	630	630/800	-	-	-	-	-	-	-
Curent de scurtcircuit de durată	1 sek.	(kA)	(kA)	5	8	8	13	26,5	26,5	35	35	50	50	50	50	50
	0,25 sek.	(kA)	(kA)	10	16	16	26	53	53	70	70	100	100	100	100	100
Capacitate de închidere pe scurtcircuit	(400V)	(kA)	(kA)	7,5	13,5	13,5	26	30	30	73,5	73,5	105	105	105	105	105
Putere nominală în funcționare AC 23A	(400V)	(kW)	(kW)	65	130	130	210	330	330	525	630	630	630	630	-	-
Siguranță fuzibilă montată amonte	gG/gL	(A)	(A)	125	250	250	400	630	630	1000	1000	1000	-	-	-	-
Curent scurtcircuit – valoare R.M.S	(kA)	(kA)	(kA)	50	50	50	50	50	50	100	100	100	-	-	-	-
Durată de viață mecanică	ciklova			10000	10000	10000	8000	8000	8000	7000	7000	4000	4000	4000	2000	2500
Durată de viață electrică	ciklova			2000	2000	2000/200	1500	1500	1500/200	1000	1000	1000	500	500	500	500
Puterea nominală reactivă la 400V	400 V	(kVar)	(kVar)	50	110	110	180	300	300	475	600	600	-	-	-	-
Pierdere de putere pe pol	(W)			2,7	3,8	6,0	9,4	15,6	25,7	27,3	12,7	38	38,3	61,3	91,7	145,5
Secțiune cablu (Cu)	mm <sup>2</sup>			70	120	185	240	2x185	2x240	-	-	-	-	-	-	-
Dimensiuni bare (Cu)	mm			16x4	20x5	20x5	2x25x5	2x32x6	2x40x6	2x50x6	2x50x8	2x50x8	3x50x8	3x50x12	4x50x12	6x50x12
Cuplu de strângere surub bornă	Nm			8	12	12	18	34	34	45	45	70	70	70	70	70
Greutate	3P	kg	kg	0,9	1,5	1,5	3,5	5,5	5,5	11	11	11	18	18	25	25
	4P	kg	kg	1	1,6	1,6	3,8	6	6	12	12	12	19,2	19,5	26,5	26,5

(1) - doi poli în serie

LA1 / D 160 – cu mâner de blocare (montaj pe ușă)

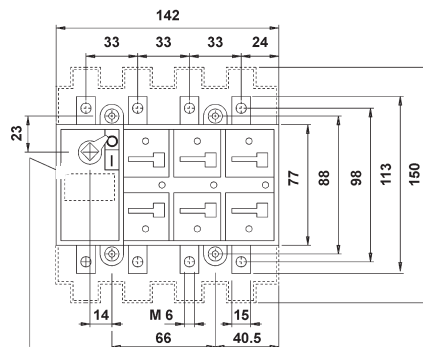
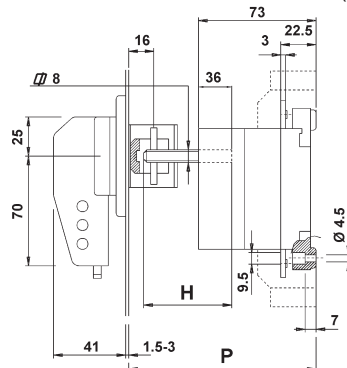

LA1 / R 160 – cu mâner direct

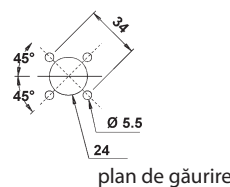
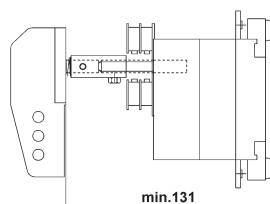

P		C	H
min	max		P-C
116	247	47	P-C



ETISWITCH

LA2 / D 250 – cu mâner de blocare (montaj pe ușă)

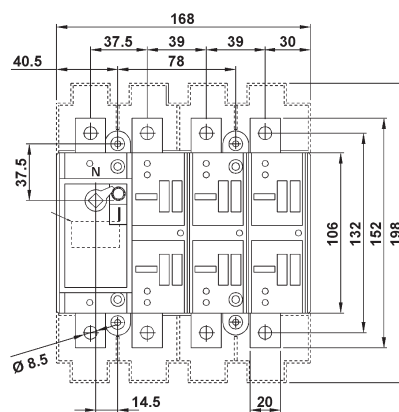
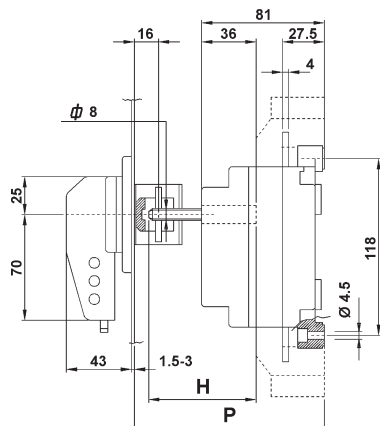

LA2 / R 250 - cu mâner direct

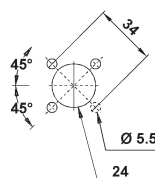
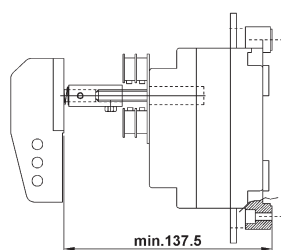

plan de găurire

P		C	H
min	max		
124	255	55	P-C

LA3 / D 400A – cu mâner de blocare (montaj pe ușă)

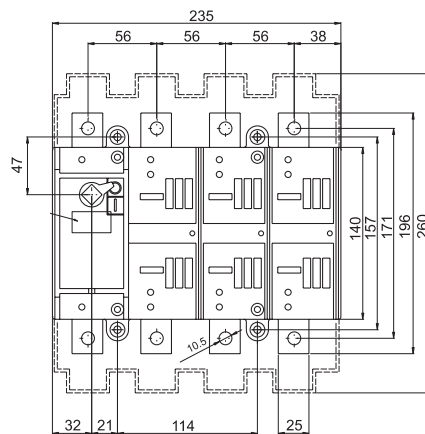
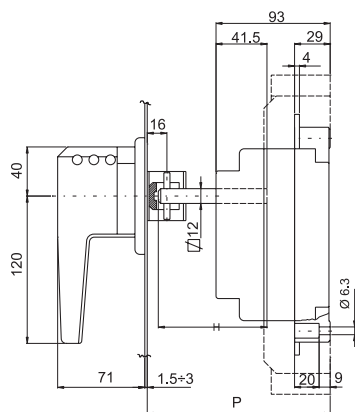

LA3 / R 400A cu mâner direct

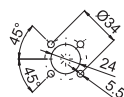
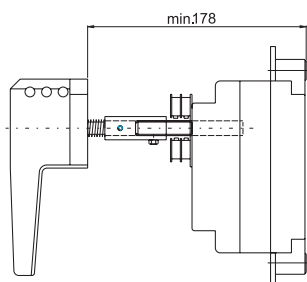

P		C	H
min	max		
148	261,5	51,5	P-C



LA4 / D 630 A - cu mâner de blocare (montaj pe uşă)

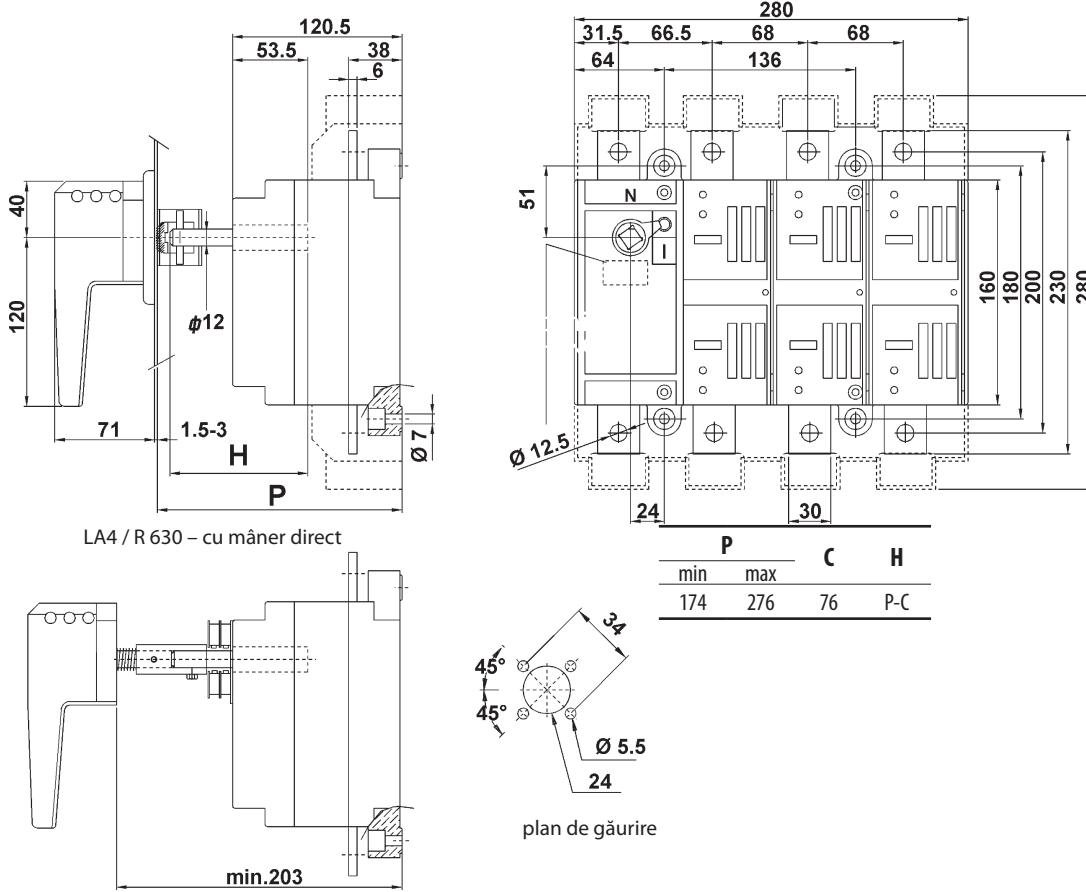

LA5 / D 1250A - cu mâner de blocare (montaj pe uşă)

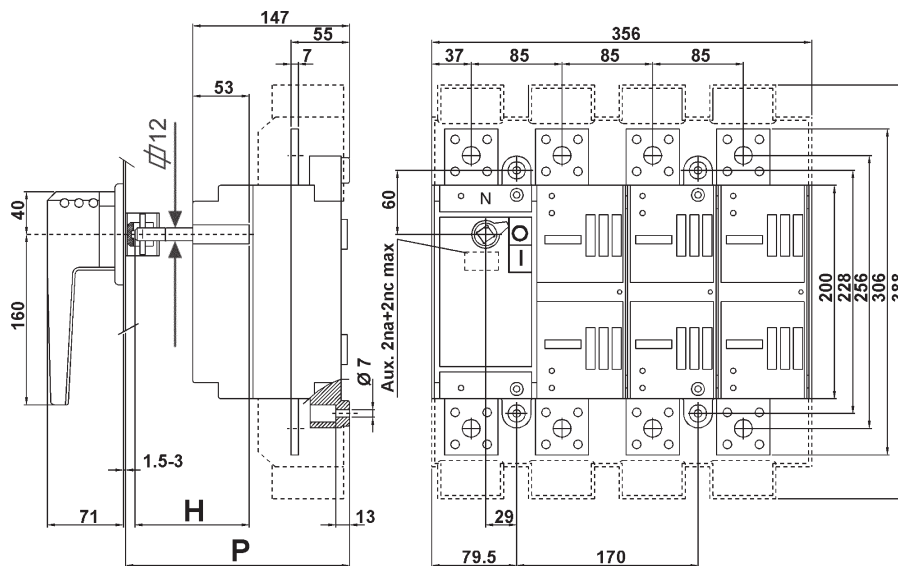



ETISWITCH

LA5 / R 1250A – cu mâner direct

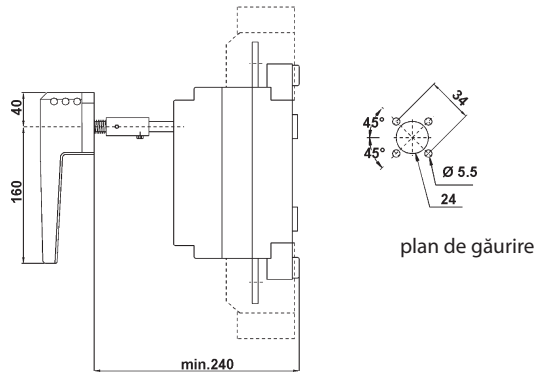

P		C	H
min	max		
215	296	96	P-C

LA5 50kA 1250 A

- cu mâner de blocare (montaj pe ușă)

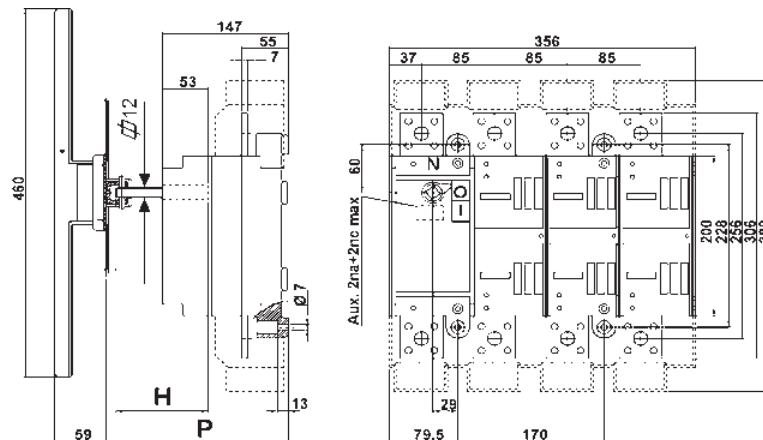

cu mâner direct

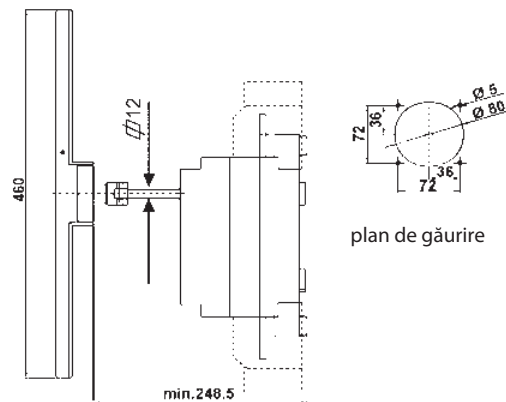

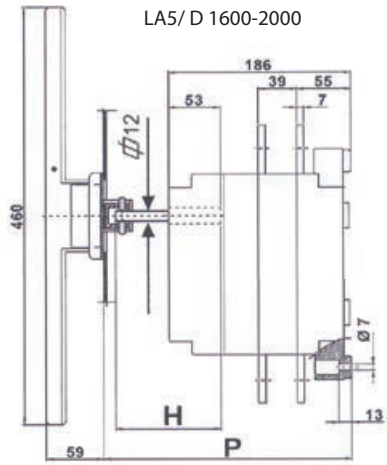

LA5/D 1600-2000

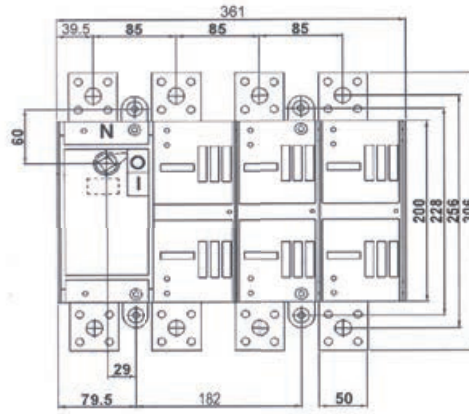

LA5/R 1600-2000

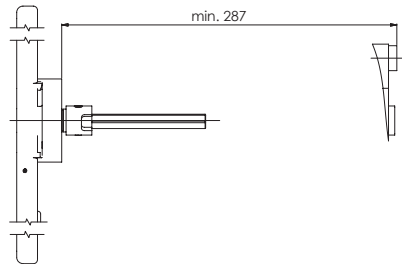

P		C	H
min	max		
252	345	145	P-C

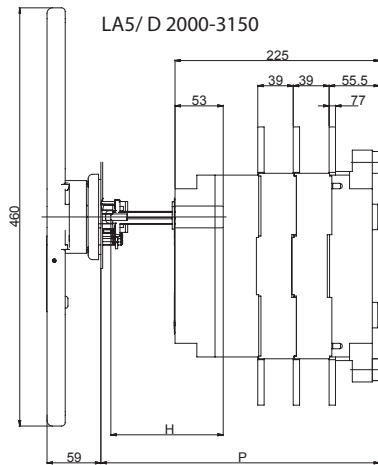

LA5/D 2000-3150

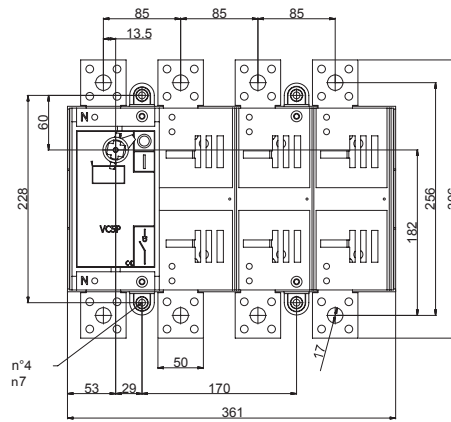

LA5/R 2000-3150

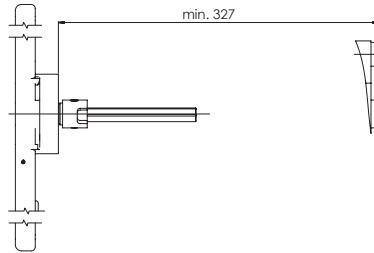

P		C	H
min	max		
291	384	184	P-C